

Generic Representation of C-Stud Scab Reinforcements

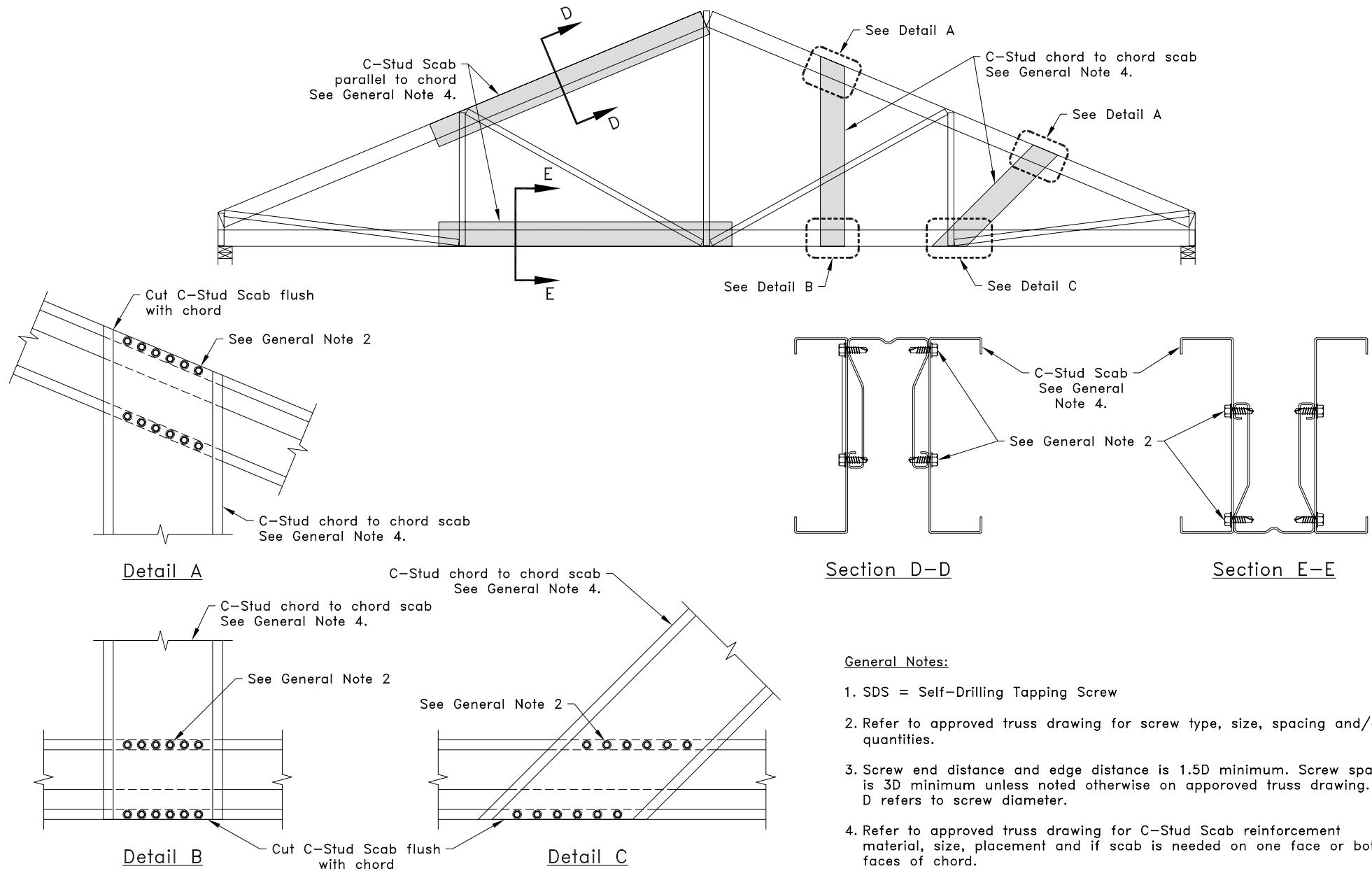

General Notes:

1. SDS = Self-Drilling Tapping Screw
2. Refer to approved truss drawing for screw type, size, spacing and/or quantities.
3. Screw end distance and edge distance is 1.5D minimum. Screw spacing is 3D minimum unless noted otherwise on approved truss drawing. D refers to screw diameter.
4. Refer to approved truss drawing for C-Stud Scab reinforcement material, size, placement and if scab is needed on one face or both faces of chord.

ALPINE TrusSteel™

www.TrusSteel.com

Generic C-Stud Scab Installation Guide

Alpine, a division of ITW Building Components Group, Inc. shall not be responsible for any performance failure in a connection due to a deviation from this detail. Any variation from this detail shall be approved in advance by Alpine, a division of ITW Building Components Group, Inc.

Standard Detail:
TS073

Date:
10/11/18

TrusSteel Detail Category:
Reinforcement

Florida: 6750 Forum Drive, Suite 305 / Orlando, FL 32821 / (800) 755-6001
Missouri: 13723 Riverport Drive, Suite 200 / Maryland Heights, MO 63043 / (800) 326-4102