

| Allowable U lbs (kN) ^A | | | | | | | | |
|--|-------------------------------|--------------------|-------------------------------|--------------------|-------------------------------|--------------------|-------------------------------|--------------------|
| Chord | Southern Pine | | Douglas Fir-Larch | | Spruce-Pine-Fir | | Hem-Fir | |
| | Clip on one face ^B | Clip on both faces | Clip on one face ^B | Clip on both faces | Clip on one face ^B | Clip on both faces | Clip on one face ^B | Clip on both faces |
| 28TSC2.75 | 400 (1.78) | 1230 (5.47) | 400 (1.78) | 1230 (5.47) | 380 (1.69) | 910 (4.05) | 400 (1.78) | 960 (4.27) |
| 33TSC2.75 | | 1530 (6.81) | | 1300 (5.78) | | | | |
| 43TSC2.75 | | 1570 (6.98) | | | | | | |
| 28TSC3.00 or 28TSC4.00 | 620 (2.76) | 1230 (5.47) | 540 (2.40) | 1230 (5.47) | 380 (1.69) | 910 (4.05) | 400 (1.78) | 960 (4.27) |
| 33TSC3.00 or 33TSC4.00 | 660 (2.94) | 1530 (6.81) | | 1300 (5.78) | | | | |
| 43 & 54TSC3.00, 43, 54, 63 & 97TSC4.00 | | 1570 (6.98) | | | | | | |

| Allowable P1 lbs (kN) ^A | | | | | | | |
|------------------------------------|--------------------|-------------------|--------------------|------------------|--------------------|------------------|--------------------|
| Southern Pine | | Douglas Fir-Larch | | Spruce-Pine-Fir | | Hem-Fir | |
| Clip on one face | Clip on both faces | Clip on one face | Clip on both faces | Clip on one face | Clip on both faces | Clip on one face | Clip on both faces |
| 600 (2.67) | 1200 (5.34) | 560 (2.49) | 1110 (4.94) | 480 (2.14) | 960 (4.27) | 490 (2.18) | 980 (4.36) |

| Allowable P2 lbs (kN) ^A | | | | | |
|------------------------------------|--------------------|------------------|--------------------|--------------------|--------------------|
| 28TSC | | 33TSC | | 43, 54, 68 & 97TSC | |
| Clip on one face | Clip on both faces | Clip on one face | Clip on both faces | Clip on one face | Clip on both faces |
| 310 (1.38) | 630 (2.80) | 340 (1.51) | 730 (3.25) | 340 (1.51) | 880 (3.91) |

A. Allowable loads shown are not in combination.
 B. Uplift connections with a clip on one face require a web above the connection.

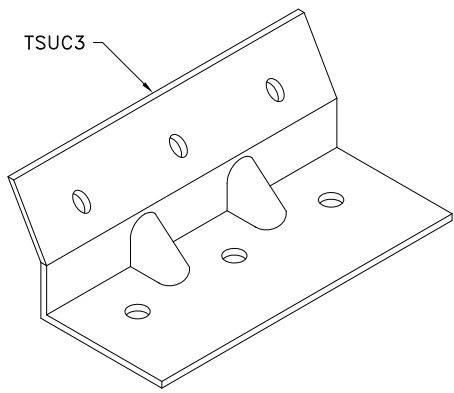
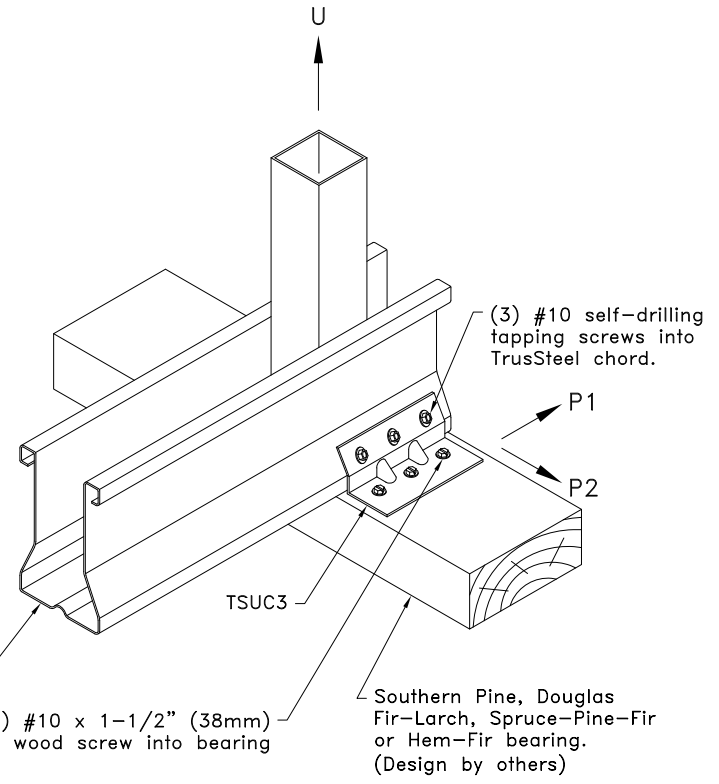

General Notes:

- 2x4 or larger bearing may be used.
- If a clip is required on both faces, attach the second clip to the opposite face of the chord as detailed.
- Multi-ply trusses require a clip on each face. Refer to TrusSteel detail drawing TS023A for ply-to-ply connections for 3-Ply trusses with a clip on each face.
- Wood screws require a lead hole to be drilled before insertion of screw. Diameter of lead hole to be 9/64" (3.57mm).
- Allowable wood screw uplift and lateral loads have been increased by 1.6 duration factor for wind and seismic loads.
- If bearing is pressure treated lumber, reference Steel Framing Alliance bulletin "Pressure Treated Wood and Steel Framing".
- Allowable fastener values into wood are per ANSI/AWC NDS-2015.
- Cold-Formed Steel Calculations are per the AISI 2016 "North American Specifications for the Design of Cold-Formed Steel Structural Members" (S100-16).

ALPINE TrusSteel[™]

www.TrusSteel.com

TSUC3 Uplift Attachment To Wood Bearing

Alpine, a division of ITW Building Components Group, Inc. shall not be responsible for any performance failure in a connection due to a deviation from this detail. Any variation from this detail shall be approved in advance by Alpine, a division of ITW Building Components Group, Inc.

Standard Detail:
 TS032
Date:
 10/11/18

TrusSteel Detail Category:
 Truss-To-Bearing: Wood

Florida: 6750 Forum Drive, Suite 305 / Orlando, FL 32821 / (800) 755-6001
 Missouri: 13723 Riverport Drive, Suite 200 / Maryland Heights, MO 63043 / (800) 326-4102