

TSJH22

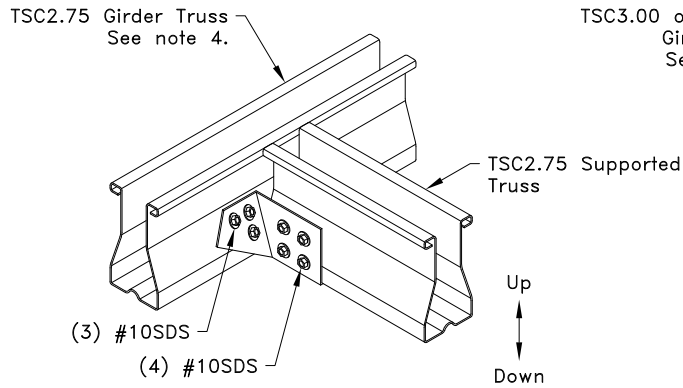

TSJH24

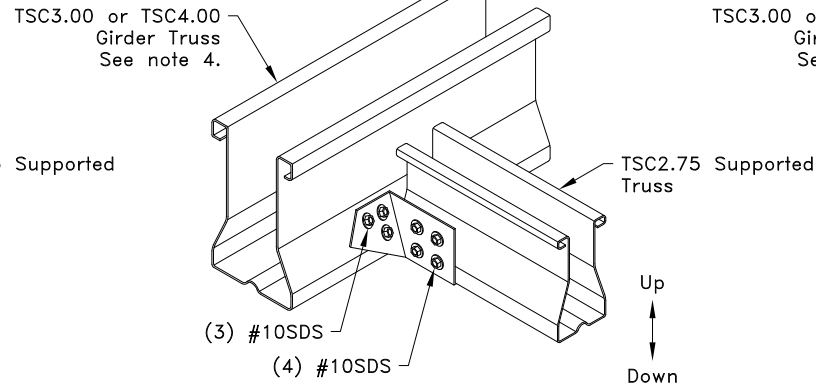

TSJH44

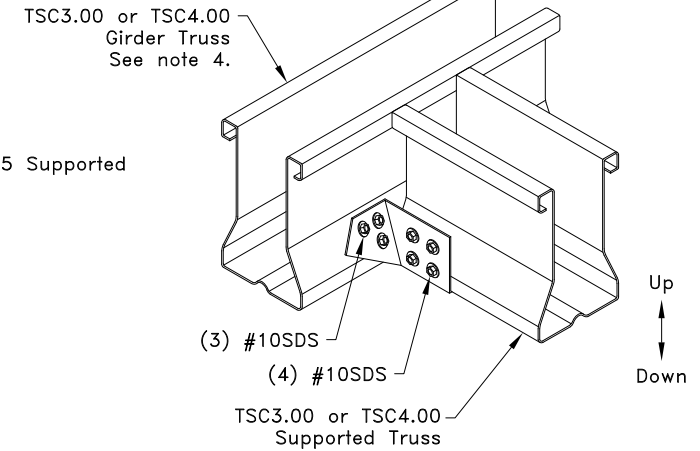

TSJH22 Allowable Loads Up and Down lbs (kN)			
Load Direction	Girder Truss		
	28TSC 22ga	33TSC 20ga	43TSC 18ga
Down	730 (3.25)	910 (4.05)	1360 (6.05)
Up - Gravity & Wind	670 (2.98)	760 (3.38)	1000 (4.45)

TSJH24 And TSJH44 Allowable Loads Up and Down lbs (kN)						
Load Direction	Girder Truss					
	28TSC 22ga	33TSC 20ga	43TSC 18ga	54TSC 16ga	68TSC 14ga	97TSC 12ga
Down	1090 (4.85)	1130 (5.03)	1330 (5.92)	1340 (5.96)	1340 (5.96)	1340 (5.96)
Up - Gravity & Wind	550 (2.45)	770 (3.43)	990 (4.40)	1200 (5.34)	1200 (5.34)	1200 (5.34)

General Notes:

1. SDS = Self-Drilling Tapping Screw. Screws to be applied through the pre-drilled holes in hanger into the TrusSteel chord. The same quantity of screws is to be applied on the side of the hanger that is not visible.
2. Do not overdrive screws. Overdriven screws may strip out of TrusSteel chord.
3. Hangers may be located anywhere along girder chords.
4. Refer to TrusSteel detail drawings TS023 or TS024 for ply-to-ply connections for multi-ply girders.
5. Cold-Formed Steel Calculations are per the AISI 2016 "North American Specifications for the Design of Cold-Formed Steel Structural Members" (S100-16).



www.TrusSteel.com

Florida: 6750 Forum Drive, Suite 305 / Orlando, FL 32821 / (800) 755-6001
 Missouri: 13723 Riverport Drive, Suite 200 / Maryland Heights, MO 63043 / (800) 326-4102

**TSJH22, TSJH24 And TSJH44
Hanger Application**

Alpine, a division of ITW Building Components Group, Inc. shall not be responsible for any performance failure in a connection due to a deviation from this detail. Any variation from this detail shall be approved in advance by Alpine, a division of ITW Building Components Group, Inc.

Standard Detail:

TS022

Date:

10/11/18

TrusSteel Detail Category:

Truss-To-Truss Connections