

12" (305mm) or 18" (457mm) Splice

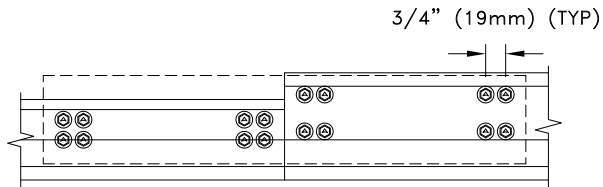

12" (305mm) or 18" (457mm) Splice

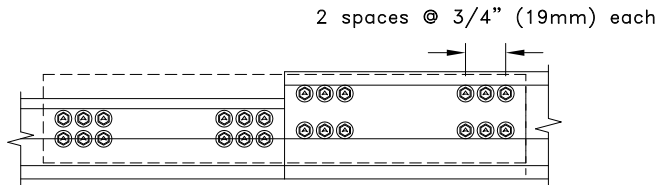

12" (305mm) or 18" (457mm) Splice

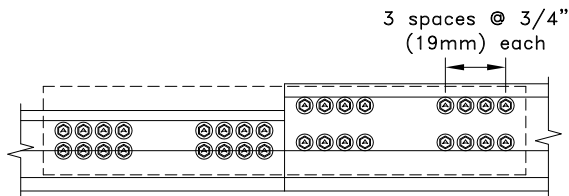

18" (457mm) Splice Only

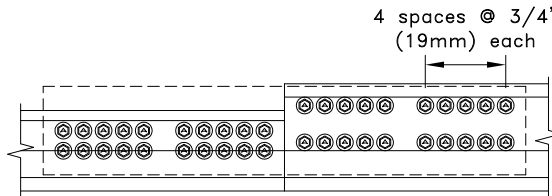

18" (457mm) Splice Only

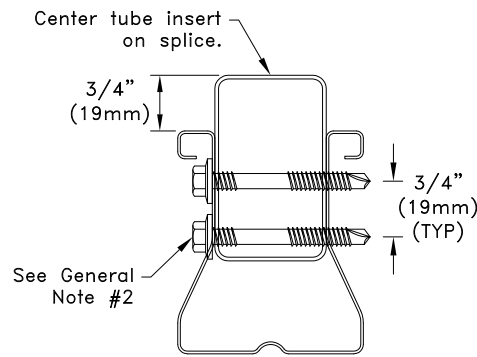

TSC3.00 With 47W1.5x2.5  
Tube Splice

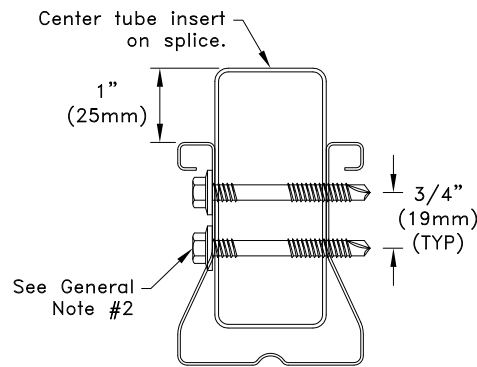

TSC3.00 With 63W1.5x3.5  
Tube Splice

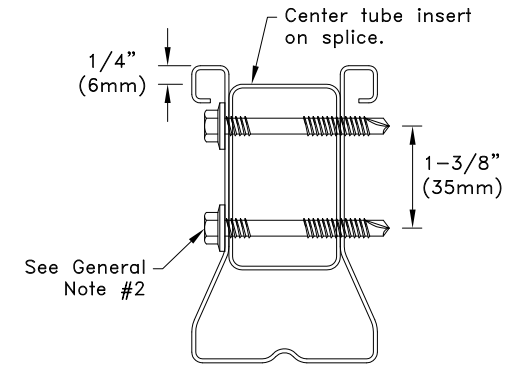

TSC4.00 With 47W1.5x2.5  
Tube Splice

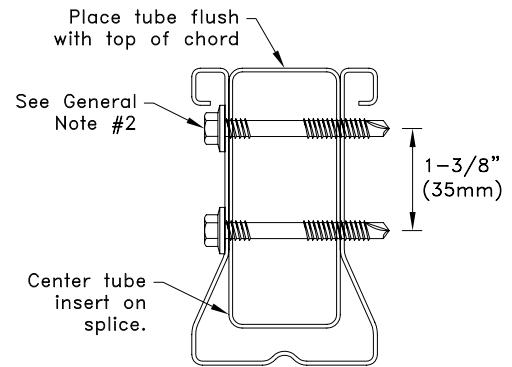

TSC4.00 With 63W1.5x3.5  
Tube Splice

**General Notes:**

1. Fastener spacing and end distance is 3/4" (19mm) minimum.
2. Fasteners may be 14AMS.75 from each side or 14AMDR2.375 from one side (14AMDB2.125 fasteners may be substituted for 14AMDR2.375 fasteners when the chord is 22g, 20g, 18g, or 16g). Refer to approved truss drawings for fastener type, splice member length, splice member type and detail call out.
3. Dimensions are typical for both sides of splice per splice detail.



www.TrusSteel.com

Florida: 6750 Forum Drive, Suite 305 / Orlando, FL 32821 / (800) 755-6001  
Missouri: 13723 Riverport Drive, Suite 200 / Maryland Heights, MO 63043 / (800) 326-4102

**TSC3.00 To TSC4.00  
Splices Using The  
"Tube Only" Splice**

Alpine, a division of ITW Building Components Group, Inc. shall not be responsible for any performance failure in a connection due to a deviation from this detail. Any variation from this detail shall be approved in advance by Alpine, a division of ITW Building Components Group, Inc.

**Standard Detail:**  
TS012G

**Date:**  
10/11/18

**TrusSteel Detail Category:**  
Chord Splices