

**General Notes:**

1. SDS = Self-Drilling Tapping Screw. Screw spacing, edge distance and end distance for #10SDS is 9/16" (14mm) minimum.
2. X refers to required number of screws at location.
3. Refer to approved bracing design for required bracing material, connections and allowable downward load.
4. Refer to approved truss drawings for piggyback truss designs. Length of bottom chord panels in piggyback trusses shall not exceed 4'-0" (1219mm).
5. Plates shown in Details A2 and B2 shall be made from 20g ASTM A653 SS Grade 33 G60, with a minimum bare metal thickness of 0.0329" (0.84mm).
6. It is permissible to substitute an equal alternative for the Simpson or Alpine hardware specified on this detail.
7. Cold-Formed Steel Calculations are per the AISI 2016 "North American Specifications for the Design of Cold-Formed Steel Structural Members" (S100-16).

**NOTICE** Uplifts values given assume that connections do NOT resist any lateral load and trusses are over continuous bearing. Contact a TrusSteel engineer for assistance.

Allowable Uplift lbs (kN) for Details A1 & A2				
X	TSC2.75		TSC3.00 or TSC4.00	
	Clip On One Face	Clip On Both Faces	Clip On One Face	Clip On Both Faces
2	410 (1.82)	820 (3.65)	410 (1.82)	820 (3.65)
3	550 (2.45)	1230 (5.47)	610 (2.71)	1230 (5.47)
4 <sup>A</sup>	550 (2.45)	1640 (7.30)	820 (3.65)	1640 (7.30)

A. Only applicable for Detail A2.

Allowable Uplift lbs (kN) for Details B1 & B2	
X	Clip On One Face
2	410 (1.82)
3	550 (2.45)

Allowable Uplift lbs (kN) for Detail C
820 (3.65)

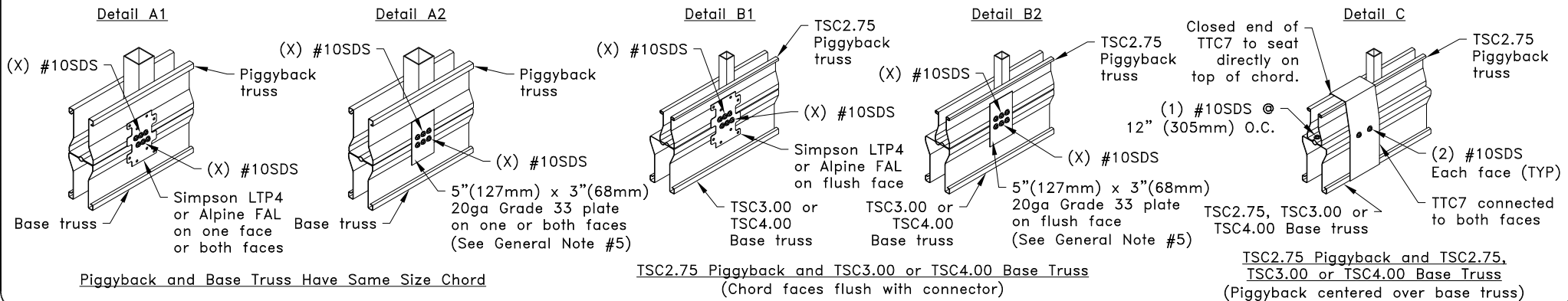

Piggyback and Base Truss Have Same Size Chord

TSC2.75 Piggyback and TSC3.00 or TSC4.00 Base Truss (Chord faces flush with connector)

TSC2.75 Piggyback and TSC2.75, TSC3.00 or TSC4.00 Base Truss (Piggyback centered over base truss)



www.TrusSteel.com

Florida: 6750 Forum Drive, Suite 305 / Orlando, FL 32821 / (800) 755-6001  
 Missouri: 13723 Riverport Drive, Suite 200 / Maryland Heights, MO 63043 / (800) 326-4102

**Piggyback Uplift Connection**  
 (Piggyback Sits Directly On Base Truss)

Alpine, a division of ITW Building Components Group, Inc. shall not be responsible for any performance failure in a connection due to a deviation from this detail. Any variation from this detail shall be approved in advance by Alpine, a division of ITW Building Components Group, Inc.

**Standard Detail:**  
 TS003B

**Date:**  
 10/11/18

**TrusSteel Detail Category:**  
 Piggybacks