

Contact a TrusSteel engineer if the approved truss drawing has been analyzed with a bearing under the bottom chord. Resisting uplift at the top chord of the truss changes the truss analysis.

Allowable U lbs (kN) <sup>A</sup>		
Chord	ETAM on One Face	ETAM on Both Faces
28TSC2.75	550 (2.45)	1210 (5.38)
33TSC2.75		1550 (6.89)
43TSC2.75		1800 (8.00)
28TSC3.00 or 28TSC4.00	590 (2.62)	1180 (5.25)
33TSC3.00 or 33TSC4.00	760 (3.38)	1520 (6.76)
43TSC3.00 or 43TSC4.00	900 (4.00)	1800 (8.00)
54TSC3.00 or 54TSC4.00		
68TSC4.00		
97TSC4.00		
Allowable P1 and P2 lbs (kN) <sup>A</sup>		
P1/P2	ETAM on One Face	ETAM on Both Faces
P1	85 (0.38)	170 (0.76)
P2	65 (0.29)	130 (0.58)

A. Allowable loads shown are not in combination.

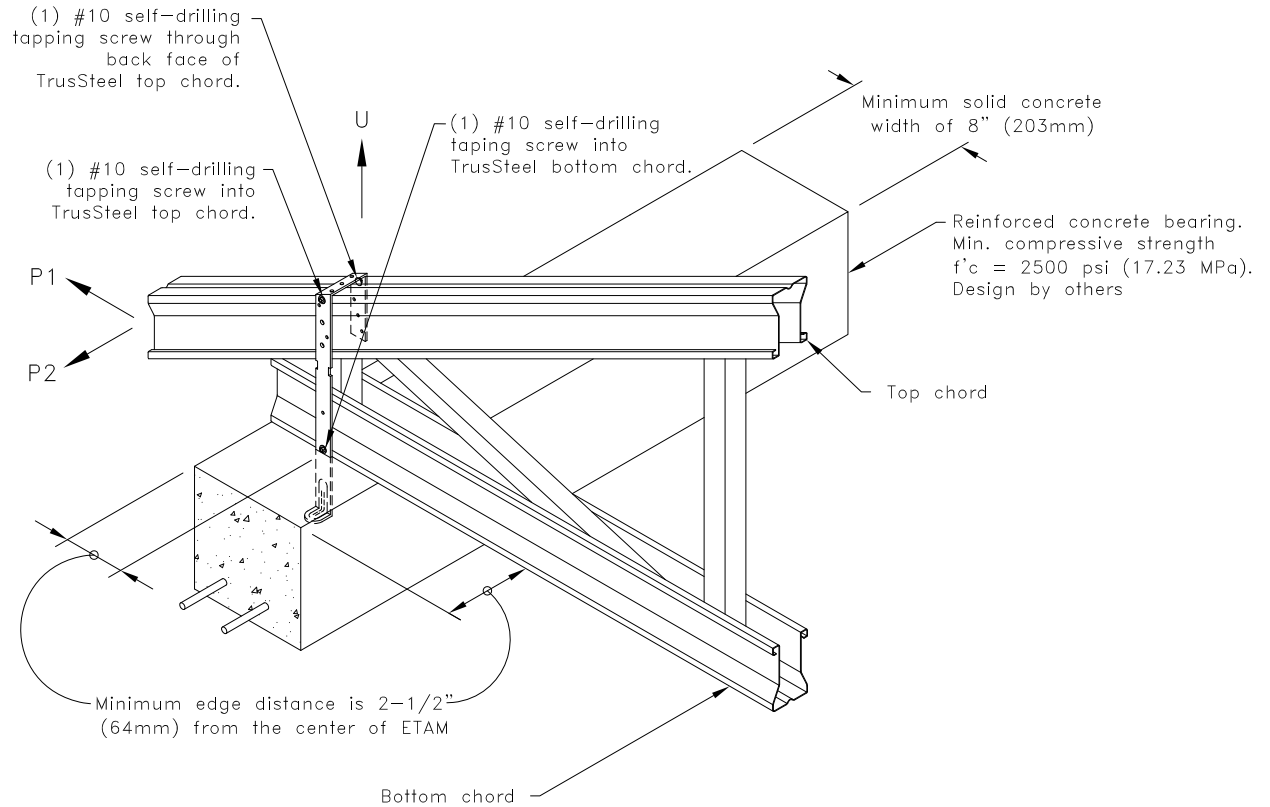

ETAM	"L" in. (mm)
ETAM16	12 (305)
ETAM18	14 (356)
ETAM20	16 (406)
ETAM22	18 (457)
ETAM24	20 (508)

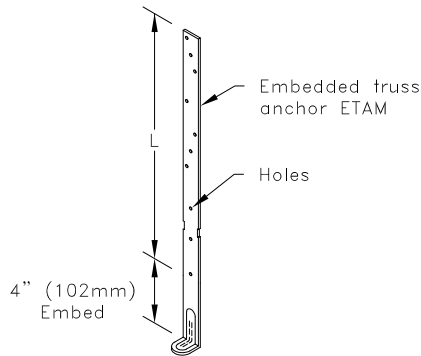

General Notes:

1. Attachment of second ETAM on opposite face of chord is identical to that detailed above.
2. Truss shall be designed with at least one vertical web over the bearing.
3. See detail above for required number of screws and placement.
4. ETAM shall be installed so it wraps over the top of the truss and returns down the back side of the top chord as shown in detail above.
5. Allowable loads shown are for use with normal weight concrete.
6. Cold-Formed Steel Calculations are per the 2010 supplement to the AISI 2007 "North American Specifications for the Design of Cold-Formed Steel Structural Members" (S100-07/S2-10).

**TrusSteel**<sup>®</sup>

www.TrusSteel.com

Florida: 1950 Marley Drive / Haines City, FL 33844 / (800) 755-6001  
Missouri: 13389 Lakefront Drive / Earth City, MO 63045 / (800) 326-4102

**ITWBCG ETAM Uplift  
Attachment Over Top Of  
Truss Into Concrete Bearing**

ITW Building Components Group, Inc. shall not be responsible for any performance failure in a connection due to a deviation from this detail. Any variation from this detail shall be approved in advance by ITW Building Components Group, Inc.

**Standard Detail:**  
TS035

**Date:**  
07/16/12

**TrusSteel Detail Category:**  
Truss-To-Bearing: Concrete